

Cast Iron

Single Part Infill Covers (Gastight)

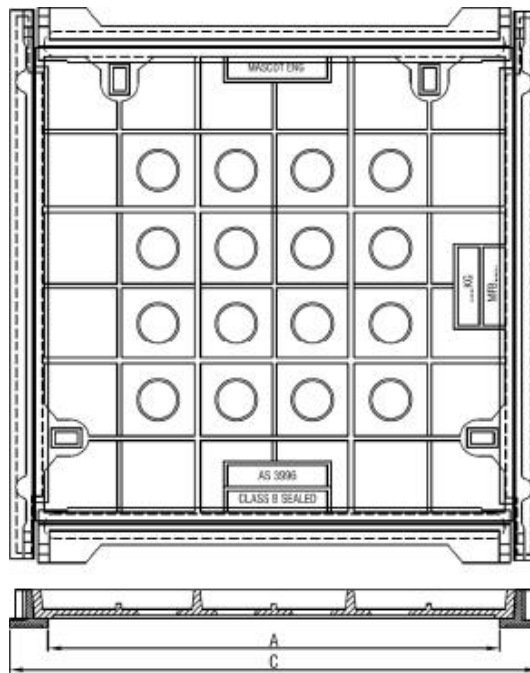

Class B

Clear Opening (A)	Overall Height (B)	Overall Size (C)	Weight	Load Rating	Product Code
300x300	50	460x410	28	Class B	MFB33
450x450	50	615x560	42	Class B	MFB44
600x450	50	760x560	48	Class B	MFB64
600x600	50	760x710	62	Class B	MFB66
750x600	50	910x710	82	Class B	MFB76
750x750	50	910x860	88	Class B	MFB77
900x600	50	1070x710	96	Class B	MFB96
900x900	50	1070x1010	145	Class B	MFB99
1200x1200	50	1435x1380	230	Class B	MFB1212

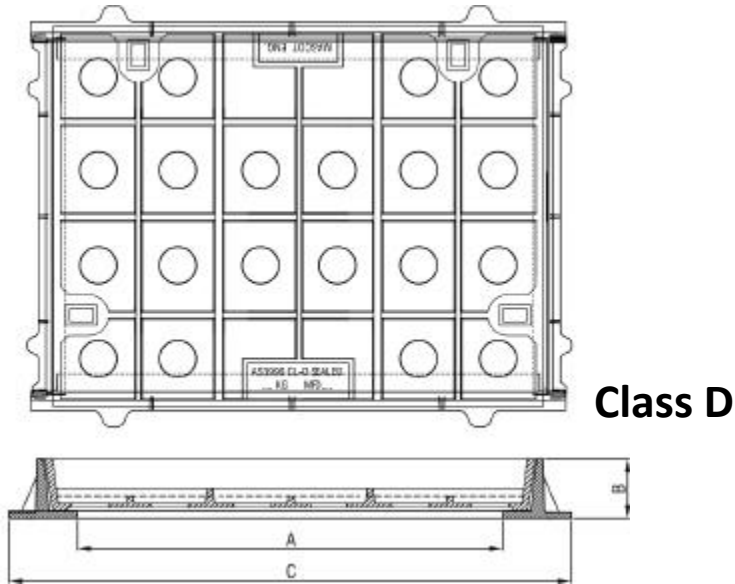

Class D

Clear Opening (A)	Overall Height (B)	Overall Size (C)	Weight	Load Rating	Product Code
300x300	50	460x410	30	Class D	MFD33
450x450	50	615x560	51	Class D	MFD44
600x450	75	780x590	65	Class D	MFD64
600x600	75	800x760	73	Class D	MFD66
750x600	75	910x710	90	Class D	MFD76
750x750	75	910x860	99	Class D	MFD77
900x600	75	1100x760	110	Class D	MFD96
900x900	75	1100x1100	160	Class D	MFD99
1200x1200	75	1374x1426	300	Class D	MFD1212
1250x450	75	1420x620	123	Class D	MFD1245